

# Maintenance Instructions: XL 8 8 m Telescopic Lance Series



SMART UND SWISS SEIT 1876

## Clearing dust blockages:

\*Dust blockage tool purchased separately.



To avoid damage do not exceed maximum 6 bar pressure.

2. Connect dust blocking tool to an air line. Begin applying air pressure to the XL 8, up to a maximum of 6 bar to dislodge the blockage.

1. Connect dust blocking tool to the XL 8 Flexi-tip.



ALWAYS ENSURE DUST PLUGS AND CAPS ARE REMOVED BEFORE COMMENCING UNBLOCKING

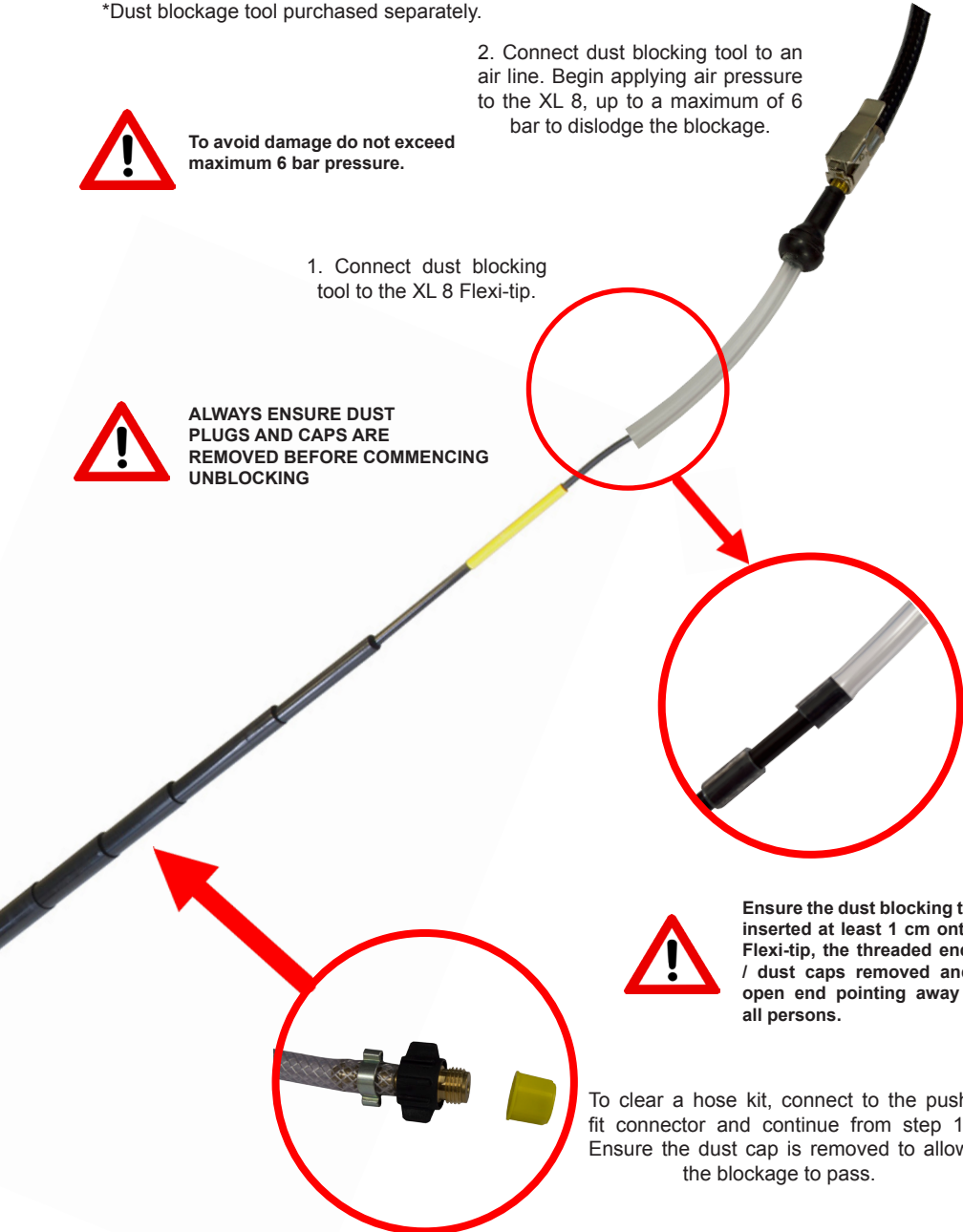

Ensure the dust blocking tool is inserted at least 1 cm onto the Flexi-tip, the threaded end cap / dust caps removed and the open end pointing away from all persons.

To clear a hose kit, connect to the push fit connector and continue from step 1. Ensure the dust cap is removed to allow the blockage to pass.